

From:Victoria Gibson
Sent:Mon, 13 Nov 2017 16:01:00 +0000
To:Planning Scanning
Subject:FW: Phoenix Gymnastics Club - planning ref 17/00997CONDIT.
Attachments:667769-DWG-SBU-C-100 Rev P3_WSP.PDF, 9443-D-01-P01.pdf, 9443-D-02-P01.pdf

From: Stevens, Richard [mailto:Richard.Stevens@wsp.com]
Sent: 13 November 2017 15:29
To: Victoria Gibson <Victoria.Gibson@RBWM.gov.uk>; Remsha Mohammed-Remla <Remsha.Mohammed-Remla@Projectcentre.co.uk>
Cc: Wheeler, Martin <Martin.Wheeler@wsp.com>; Phil Rowe <Phil.Rowe@Kerrington.co.uk>; Ian Dobie <Ian.Dobie@farmglade.co.uk>
Subject: Phoenix Gymnastics Club - planning ref 17/00997CONDIT.

Dear Remsha and Victoria

Please find attached drawings illustrating the new proposals for surface water drainage at Phoenix Gymnastics Club following the meeting held on 13th October 2017. We trust these are in line with the approach agreed at the meeting and the meeting minutes which Martin contributed to last week. These comprise:

- General arrangement drawing (9443-D-01) showing proposed changes to the surface water drainage system
- Key Sections drawing (9443-D-02); and,
- Amended Below Ground Drainage Layout – Drawing 667769-DWG-SBU-C-100.

If you have any queries please contact myself or Martin Wheeler.

Kind regards

Richard Stevens

Richard Stevens BSc (Hons) MSc MCIWEM C.WEM CSci

Senior Engineer



T+ 44 (0)1256 318746

Mountbatten House, Basing View,

Basingstoke, Hampshire,

RG21 4HJ

wsp.com

Confidential

This message, including any document or file attached, is intended only for the addressee and may contain privileged and/or confidential information. Any other person is strictly prohibited from reading, using, disclosing or copying this message. If you have received this message in error, please notify the sender and delete the message. Thank you.

WSP UK Limited, a limited company registered in England & Wales with registered number 01383511. Registered office: WSP House, 70 Chancery Lane, London, WC2A 1AF.



Details superseded by WSP Drawings 9443-D-01 and 9943-D-02

PRIVATE DRAINAGE LEGEND
FOUL WATER:

- FOUL WATER DRAIN
- PRIVATE MANHOLE
- INSPECTION CHAMBER 450Ø (1.2M MAX DEPTH)
- ACCESS FITTING 225Ø (0.6M MAX DEPTH)
- FOUL CONNECTIONS:
SVP=SOIL VENT PIPE
AAV=AIR ADMITTANCE VALVE
BIB=BACK INLET GULLY
FS=FLOOR SOCKET
SS=STUB STACK
FA= FROM ABOVE
- FOUL FLOOR GULLY (TRAPPED AND RODDABLE)

GENERAL:

PIPEWORK OTHER THAN THAT COVERED BY THE NOTES SHALL BE IDENTIFIED THUS:-

150Ø/100

SHOWS INTERNAL DIAMETER OF PIPE IN mm
SHOWS APPROXIMATE GRADIENT E.G. 1 IN 100

AT MANHOLES AND INSPECTION CHAMBERS:
BD = BACKDROP,
UIL = UPPER INVERT LEVEL

SURFACE WATER:

- SURFACE WATER DRAIN
- PERFORATED PIPE LAID WITHIN TYPE 3 SUB-BASE
- PRIVATE MANHOLE
- INSPECTION CHAMBER 450Ø (1.2M MAX DEPTH)
C = CATCHPIT MANHOLE
S = SILT TRAP 500Ø
- RODDING EYE
- RAINWATER DOWNPIPE
- ROAD GULLY (TRAPPED AND RODDABLE)
- DRAINAGE CHANNEL
- REINFORCED GRASS
- PERMEABLE PARKING BAYS

EXISTING:

- EX. PIPEWORK MAINTAINED
- EX. PIPEWORK TO BE ABANDONED

NOTES:

- THIS DRAWING IS TO BE READ IN CONJUNCTION WITH ALL RELEVANT ENGINEER'S, ARCHITECT'S AND SPECIALIST'S DRAWINGS AND THE SPECIFICATION.
- DO NOT SCALE FROM THIS DRAWING MANUALLY OR ELECTRONICALLY. WRITTEN PERMISSION MUST BE OBTAINED FROM MLM PRIOR TO SCALING ELECTRONICALLY OR USING THIS ELECTRONIC FILE.

CONSTRUCTION (DESIGN AND MANAGEMENT) REGULATIONS 2015

DESIGNERS HAZARD INFORMATION FOR CONSTRUCTION

- IF YOU DO NOT FULLY UNDERSTAND THE RISKS INVOLVED DURING THE CONSTRUCTION OF THE ITEMS INDICATED ON THIS DRAWING ASK YOUR MANAGER, HEALTH & SAFETY ADVISOR OR A MEMBER OF THE DESIGN TEAM BEFORE PROCEEDING.
- SERVICES TO BE LOCATED
- MANUAL LIFTING/HANDLING
- HOT MATERIAL WORKING
- CUTTING/ DUST
- LIVE SEWER FLOWS/ LEPTOSPIROSIS
- DEEP EXCAVATIONS, COLLAPSE/ FALLING
- LIVE TRAFFIC FLOWS

ALL WORKS TO BE CARRIED OUT BY SUITABLY TRAINED OPERATIVES PROVIDED WITH CORRECT PPE.

THE ABOVE NOTES REFER SPECIFICALLY TO THE INFORMATION SHOWN ON THIS DRAWING. REFER TO THE HEALTH AND SAFETY PLAN FOR FURTHER INFORMATION.

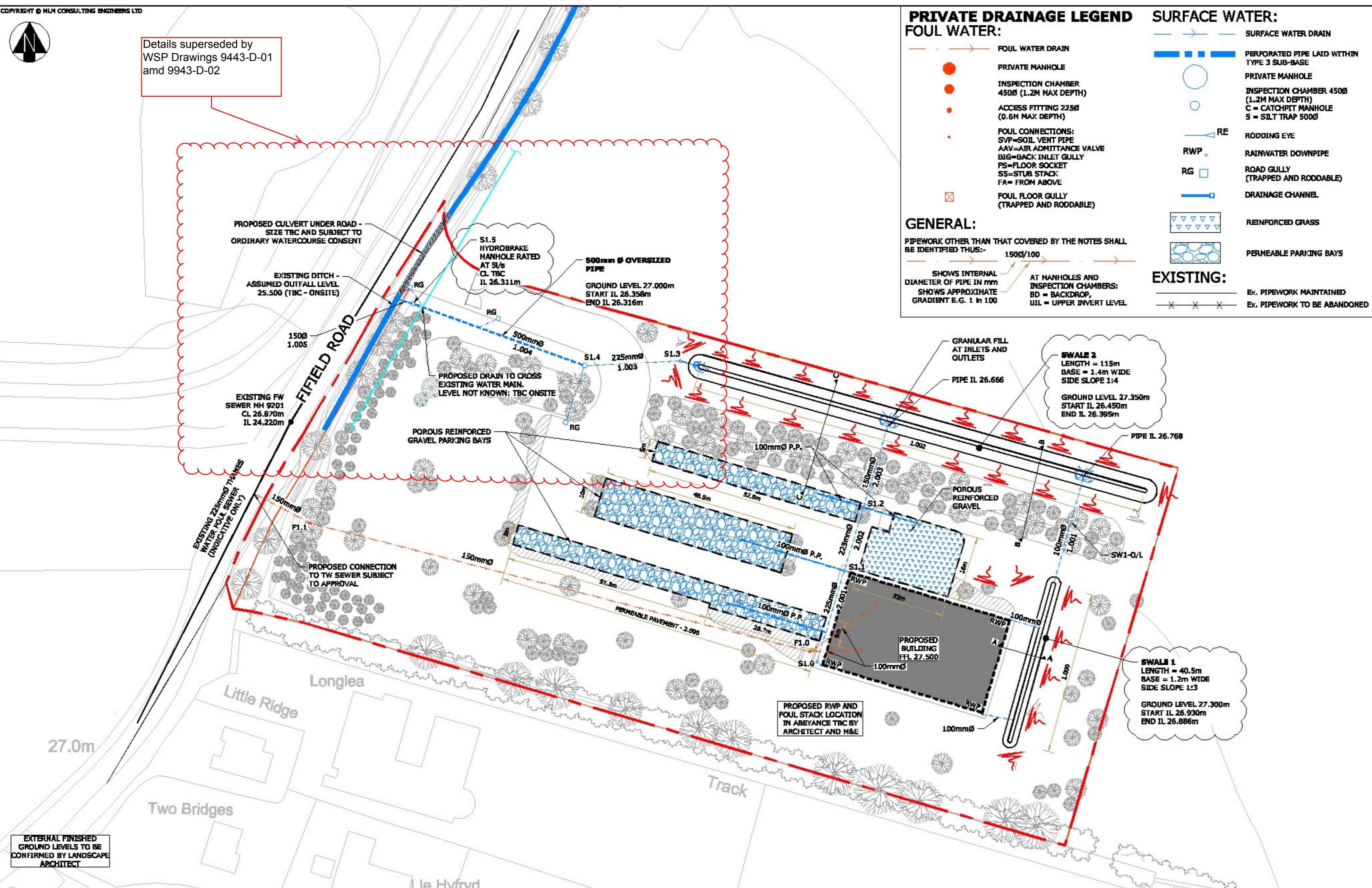

GENERAL DRAINAGE NOTES

- ALL DRAINAGE WORKS SHALL BE IN ACCORDANCE WITH THE BUILDING REGULATIONS APPROVED DOCUMENT H AND BRITISH STANDARD EN 752.
- PRIOR TO COMMENCEMENT OF THE WORKS THE CONTRACTOR SHALL LIAISE WITH ALL RELEVANT AUTHORITIES TO OBTAIN THEIR REQUIREMENTS AND TO OBTAIN APPROVAL FOR HIS METHOD OF WORKING AND WHERE APPROPRIATE HIS INTENDED CHOICE OF MATERIALS.
- REFER TO SITE SURVEY FOR DETAILS OF EXISTING SITE CONDITIONS AND BENCH MARKS.
- PRIOR TO COMMENCEMENT OF THE WORKS THE CONTRACTOR SHALL LIAISE WITH ALL RELEVANT AUTHORITIES TO LOCATE, PROTECT AND WHERE NECESSARY DIVERT ALL EXISTING SERVICES AFFECTED BY THE WORKS.
- ALL EXCAVATIONS SHALL BE KEPT FREE OF STANDING WATER.
- THE CONTRACTOR SHALL ENSURE THE STABILITY OF ALL EXCAVATIONS IS MAINTAINED AT ALL TIMES.

- ALL WORKS IN OR ADJACENT TO THE PUBLIC HIGHWAY SHALL BE IN ACCORDANCE WITH THE REQUIREMENTS OF THE HIGHWAY AUTHORITY. THE CONTRACTOR SHALL OBTAIN ALL NECESSARY LICENCES TO CARRY OUT WORKS WITHIN THE PUBLIC HIGHWAY.
- ALL WORKS TO NEW OR EXISTING PUBLIC SEWERS SHALL BE TO THE APPROVAL OF THE WATER AUTHORITY AND IN ACCORDANCE WITH 'SEWERS FOR ADOPTION 6TH EDITION' + INTERIM TECHNICAL ADDENDUM NO.1.
- PRIOR TO COMMENCEMENT OF THE WORKS ALL DRAINAGE OUTFALL POINTS, WHETHER EXISTING SEWER, DRAIN OR WATERCOURSE, SHALL BE VERIFIED ON SITE BY THE CONTRACTOR. IF THE OUTFALL POINT IS FOUND TO BE HIGHER OR SIGNIFICANTLY LOWER THAN SHOWN ON THE DRAWINGS THEN THE CONTRACT ADMINISTRATOR SHALL BE NOTIFIED IMMEDIATELY. (SIGNIFICANT REDESIGN OF DRAINAGE AND LEVELS MAY BE NECESSARY). PRIOR TO COMMENCEMENT OF CONSTRUCTION ON-SITE THE CONTRACTOR SHALL INSTALL ALL OFF-SITE DRAINAGE CONNECTIONS, OR SATISFY HIMSELF THAT THERE ARE NO OBSTRUCTIONS OR OTHER REASONS WHY, THE DRAIN CONNECTIONS CAN NOT BE MADE.
- ALL COVER LEVELS SHOWN ON THIS DRAWING ARE APPROXIMATE. EXACT LEVELS OF NEW COVERS AND FRAMES TO BE DETERMINED ON SITE TO MATCH LEVEL AND PROFILE OF FINISHED SURFACE.

- THE CONSTRUCTION OF ALL EXISTING CHAMBERS, GULLIES ETC. AND THEIR COVERS, GRATINGS AND FRAMES TO BE IMPROVED, REPAIRED OR REPLACED AS NECESSARY TO SUIT THEIR LOCATION WITHIN THE FINISHED DEVELOPMENT.
- ALL COVERS, GRATINGS AND FRAMES TO CHAMBERS, GULLIES, CHANNELS ETC. SHALL BE OF THE CORRECT LOAD CLASS TO SUIT THEIR LOCATION.
 - LOAD CLASS B125 PEDESTRIAN AREAS / CAR PARKING (NOT ACCESSIBLE BY HEAVY GOODS VEHICLES)
 - LOAD CLASS D400 AREAS ACCESSIBLE TO HGVS.
 - GRATINGS IN PEDESTRIAN AREAS TO BE DESIGNED FOR PEDESTRIAN USE, AND VICE VERSA FOR GRATINGS IN ROADS.
- ALL EXISTING CHAMBERS, GULLIES CHANNELS, PIPES AND OTHER DRAINAGE APPARATUS SHALL BE PROTECTED FROM DAMAGE DURING THE WORKS. THE CONTRACTOR SHALL TAKE ALL NECESSARY MEASURES TO ENSURE THAT NO MATERIAL ENTERS THE DRAINS (OTHER THAN THAT WHICH THEY ARE DESIGNED TO CARRY).
- REFER TO SITE INVESTIGATION REPORT FOR EXISTING GROUND CONDITIONS AND ANY SPECIAL REQUIREMENTS FOR BURIED CONCRETE (SPECIAL REQUIREMENTS FOR BURIED CONCRETE SHALL INCLUDE ALL PRE-CAST AND IN-SITU CONCRETE AND MORTARS). WHERE APPROPRIATE REFER TO CONTAMINATION

- REPORTS FOR DETAILS OF CHEMICALS AFFECTING CHOICE OF MATERIALS AND OTHER ADDITIONAL REQUIREMENTS.
- ALL PRE-CAST AND IN-SITU CONCRETE AND MORTARS USED IN THE CONSTRUCTION OF FOUL DRAINS AND SEWERS SHALL BE MADE FROM SULPHATE RESISTING CEMENT.
 - UNLESS NOTED OTHERWISE ALL SURFACE WATER DRAINAGE PIPEWORK SHALL BE 150MM DIAMETER LAID TO A FALL OF 1 IN 150 OR STEEPER.
 - UNLESS NOTED OTHERWISE FOUL WATER DRAINS SHALL BE 100MM DIAMETER LAID TO A FALL OF 1 IN 40 OR GREATER. FOUL DRAINS WITH ONE OR MORE W.C. CONNECTED MAY BE LAID AT 1 IN 80 OR STEEPER.
 - UNLESS NOTED OTHERWISE PIPE WORK CAN BE CONSTRUCTED FROM ANY OF THE FOLLOWING:
 - UPVC TO BS EN 1401
 - POLYPROPYLENE TO BS EN 1852
 - 'SUPER STRENGTH' VITRIFIED CLAY TO BS 65, BS EN 295
 - DUCTILE IRON TO BS 598
 - CLASS H CONCRETE TO BS 5911
 - THE CONTRACTOR'S ATTENTION IS DRAWN TO DIAGRAMS 7 AND 8 OF 'THE BUILDING REGULATIONS APPROVED DOCUMENT H' SHOWING DETAILS OF DRAINS LAID BELOW AND NEAR TO

- BUILDINGS, WHERE GROUND BEAMS ARE USED, THEIR LEVEL SHALL BE SET TO AVOID CLASHING WITH DRAIN CONNECTIONS.
- EXACT LOCATION OF GULLIES TO BE DETERMINED ON SITE TO SUIT LOW POINTS. THE CONTRACTOR SHALL ENSURE THAT ALL FINISHED SURFACE ARE LAID TO FALLS THAT ARE SUFFICIENT FOR ALL SURFACE WATER TO DRAIN WITHOUT SURFACE PONDING.
 - FOR THE EXACT LOCATION OF SOIL PIPES, STUBSTACKS, W.C.'S AND OTHER DRAINAGE CONNECTIONS REFER TO THE LARGE SCALE ARCHITECTURAL BUILDING PLANS.
 - RAINWATER DOWNPIPES THAT DO NOT CONNECT DIRECTLY TO AN ACCESS POINT, SHALL BE FITTED WITH A RODDING ACCESS.
 - ALL DRAINAGE CHANNELS TO BE ACO OR SIMILAR APPROVED AND TO BE OF A TYPE SIZE AND CAPACITY SUITABLE FOR THEIR LOCATION.
 - THE HEAD OF EACH PROPOSED FOUL SEWER IS TO BE VENTED.
 - ALL CATCHPITS AND SILT TRAPS TO BE REGULARLY CLEANED AND MAINTAINED FOLLOWING INSTALLATION TO ALLOW THE SW SYSTEM TO OPERATE AT ITS FULL CAPACITY. UN-MAINTAINED SILT BUILD UP CAN LEAD TO INSUFFICIENT PIPE FLOWS DUE TO RESTRICTED ACCESS AND CAN RESULT IN SURFACE PONDING.

Issue	Date	Description	Made	Checked
P3	20/12/2016	DIMENSIONS OF SWALES 1 & 2 AMENDED, DIMENSIONS OF PERMEABLE PARKING AND HYDROBRAKE MANHOLE ADDED	DOC	CB
P2	23/09/2016	GRATE PLATE S3.0 ADDED, SWALE 3 REMOVED AND REPLACED WITH OVERSIZED PIPE AS CLOUDED	DOC	BF
P1	02/09/2016	ISSUED FOR INFORMATION	CC	BF

Drawing Status: INFORMATION

MLM
Multidisciplinary Consulting

3rd Floor Eldon House, 2 Eldon Street, London EC2M 7LS
Tel: 020 7422 7800 Fax: 020 7426 2095
Website: www.mlm.uk.com

Client: FELTHAM CONSTRUCTION LTD.

Project: NEW PHOENIX GYMNASTICS CLUB

Drawing Title: BELOW GROUND DRAINAGE LAYOUT

Drawn/Design	DOC/CC	Date	SEPTEMBER 2016	Scale	1:500	Sheet	of 11
Checked	BF	Approved	BF		1:1000		of 11

Drawing No. **667769-DWG-SBU-C-100** Rev **P3**

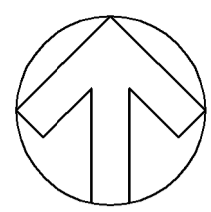

KEY:

	SITE BOUNDARY
	PROPOSED SURFACE WATER PIPE
	PROPOSED MANHOLE
	PERMEABLE PARKING BAYS
	PROPOSED ROAD GULLY
	PROPOSED HEADWALL
	EXISTING WATER MAIN (ASSUMED LOCATION)
	FOUL SEWER (ASSUMED LOCATION)

- DO NOT SCALE**
- NOTES
- THIS GENERAL ARRANGEMENT IS NOT TO BE USED FOR CONSTRUCTION. IT IS A COMPOSITE DRAWING SHOWING THE SPATIAL RELATIONSHIP BETWEEN THE PROPOSED AND EXISTING FEATURES. REFERENCE SHOULD BE MADE TO THE RELEVANT SPECIFIC CONSTRUCTION PLANS, GENERALLY SHOWN ON RP (ROAD PAVING) AND D (DRAINAGE) DRAWING.
 - THIS DRAWING SHOULD BE READ IN CONJUNCTION WITH ALL RELEVANT DOCUMENTATION, DRAWINGS AND STANDARD DETAILS. THE DESIGN HAS BEEN DEVELOPED & AGREED THROUGH CONSULTATION WITH THE THE RELEVANT AUTHORITIES (HIGHWAYS, SEWERAGE, PLANNING AND SAB).
 - IN ACCORDANCE WITH THE CDM REGULATIONS RESIDUAL RISKS OF SIGNIFICANCE ARE INDICATED ON THE GA DRAWING ONLY BY MEANS OF A HAZARD TRIANGLE WITH APPROPRIATE NOTE.
 - INFORMATION REGARDING THE LOCATION AND DEPTH OF EXISTING SERVICES CANNOT BE GUARANTEED BY THE STATUTORY UNDERTAKER.
 - THE CONTRACTOR SHALL CONDUCT THE WORKS WITH DUE REGARD TO THE ECOLOGICAL, ENVIRONMENTAL REQUIREMENTS OF THE SCHEME.
 - THE CONTRACTOR SHALL TAKE SUCH STEPS TO SAFEGUARD AGAINST CONTAMINATION OF LOCAL WATERCOURSES.
 - CONFLICTING INFORMATION SHOWN ON THE ENGINEER'S DRAWINGS OR DISCREPANCIES BETWEEN THE INFORMATION GIVEN BY THE ENGINEER AND THAT PROVIDED BY OTHERS MUST BE REFERRED TO THE ENGINEER BEFORE THE WORKS COMMENCE.
 - DIMENSIONS SHALL NOT BE SCALED FROM THIS DRAWING. ALL DIMENSIONS SHOWN ARE IN METRES. DIMENSIONS MARKED 'DIMENSIONS TO BE SITE CHECKED' ARE SUBJECT TO CONFIRMATION BY THE CONTRACTOR BEFORE THE WORKS COMMENCE.
 - TEMPORARY WORKS DESIGN ASSOCIATED WITH THE CONSTRUCTION OF THE WORKS SHALL BE RESPONSIBILITY OF THE CONTRACTOR.
 - CALCULATIONS AND DRAWINGS OF ALL CONTRACTOR DESIGNED ITEMS SHALL BE SUBMITTED TO THE ENGINEER FOR COMMENTS / APPROVALS NOT LESS THAN 10 DAYS PRIOR TO CONSTRUCTION. ANY COMMENTS MADE BY THE ENGINEER DO NOT ABSOLVE THE CONTRACTOR OF HIS DESIGN RESPONSIBILITIES.
 - THE CONTRACTOR SHALL MAINTAIN FREE AND OPEN ACCESS TO PUBLIC HIGHWAY AND ADJACENT LANDS AT ALL TIMES DURING THE COURSE OF THE WORKS UNLESS OTHERWISE AGREED IN WRITING WITH THE INTERESTED PARTIES.
 - THE CONTRACTOR SHALL BE RESPONSIBLE FOR THE DESIGN OF ALL TRAFFIC MANAGEMENT PROPOSALS & PHASING. SUCH DETAILS SHALL BE SUBMITTED TO THE LOCAL HIGHWAY AUTHORITY FOR APPROVAL PRIOR TO THE START OF THE WORKS. THE CONTRACTOR SHALL BE RESPONSIBLE FOR ALL ASSOCIATED COSTS AND ORDERS.
 - THIS DRAWING SHALL BE READ IN CONJUNCTION WITH ALL RELATED DOCUMENTATION, DRAWINGS AND STANDARD DETAILS.
 - THIS DRAWING SHALL BE READ IN CONJUNCTION WITH DRAWING 9443/D/02 PROPOSED SURFACE WATER DRAINAGE SECTIONS.
 - ALL DRAINAGE OUTFALLS AND CONNECTIONS TO EXISTING SYSTEMS SHALL BE CHECKED & SURVEYED AND THE RESULTS PASSED TO THE OVERSEEING AUTHORITY / CLIENT IN ADVANCE OF THE START OF DRAINAGE WORKS.
 - ALL WORKS AND PROGRAMMING SHALL BE AGREED IN ADVANCE WITH THE OVERSEEING ORGANISATION AND THE CLIENT.
 - REFER TO MLM DRAWING 667769-DWG-SBU-C-100-P3 FOR SITE WIDE DRAINAGE LAYOUT.

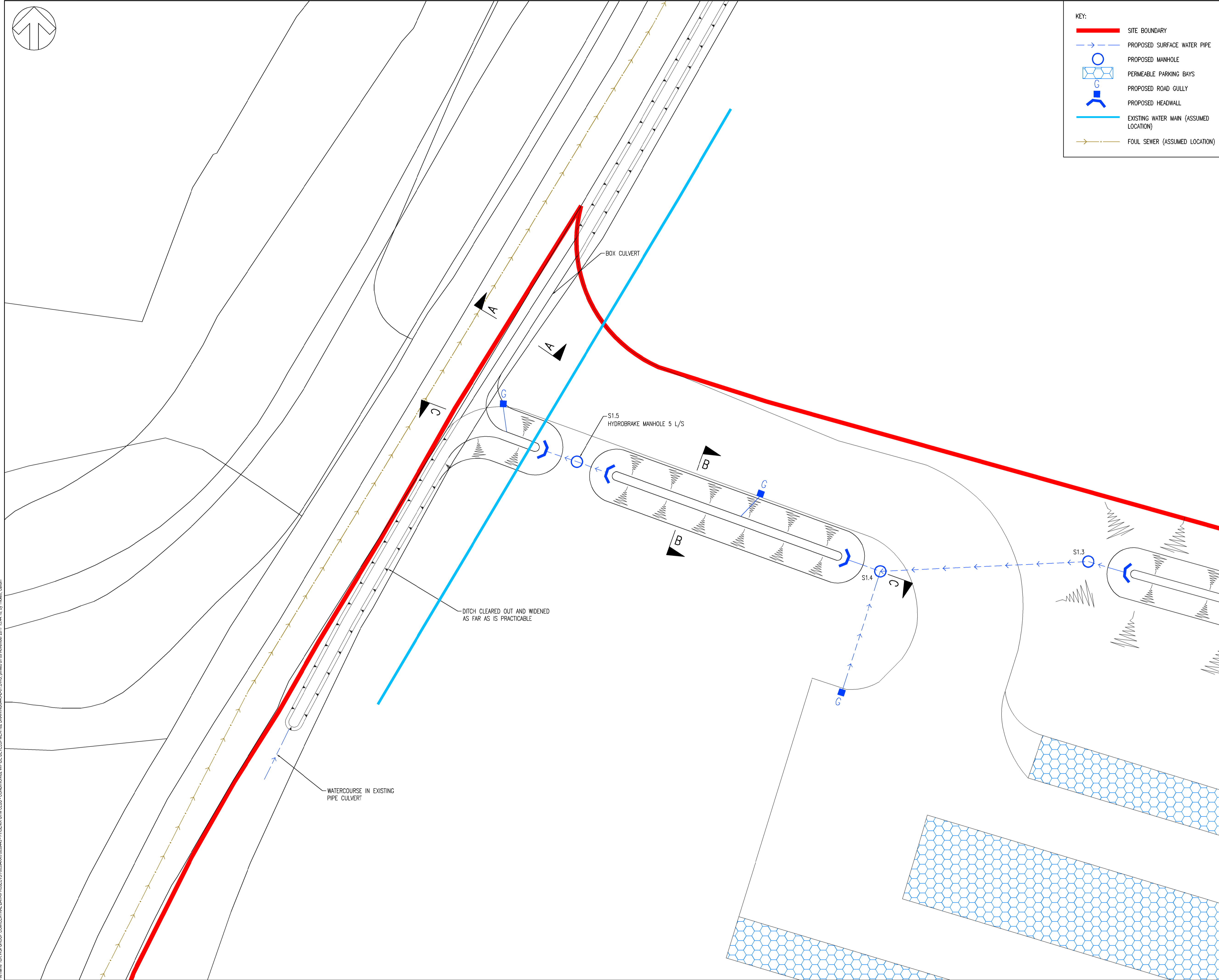

P01	09/11/2017	CT	FIRST ISSUE	RS	MP/19
REV	DATE	BY	DESCRIPTION	CHK	APP

DRAWING STATUS: **S2 - FOR INFORMATION**

Mountbatten House, Basing View, Basingstoke, RG21 4HJ, UK
T+ 44 (0) 1256 318 800, F+ 44 (0) 1256 318 700
wsp.com

CLIENT: **WATER OAKLEY LTD**

ARCHITECT: -

SITE/PROJECT: **PHEONIX GYMNASTICS CLUB**

TITLE: **PROPOSED SURFACE WATER DRAINAGE OUTFALL LAYOUT**

SCALE @ A1:	1:200	CHECKED:	RS	APPROVED:	MHW
PROJECT NO:	70039443	DESIGNED:	CT	DATE:	November 17

DRAWING NO: **9443-D-01** REV: **P01**

© WSP UK Ltd

File name: \\UK.VSPGROUP.COM\CENTRAL_DATA\PROJECTS\70039443\008443 - PHOENIX GYM CLUB - CONDITIONING W/PODE DEVELOPMENT\02 DRAWINGS\9443-D-01.DWG, issued on 09 November 2017 15:44:18, by 'Theat', Culum

DO NOT SCALE

NOTES

- THIS GENERAL ARRANGEMENT IS NOT BE USED FOR CONSTRUCTION. IT IS A COMPOSITE DRAWING SHOWING THE SPATIAL RELATIONSHIP BETWEEN THE PROPOSED AND EXISTING FEATURES. REFERENCE SHOULD BE MADE TO THE RELEVANT SPECIFIC CONSTRUCTION PLANS, GENERALLY SHOWN ON RP (ROAD PAVING) AND D (DRAINAGE) DRAWING.
- THIS DRAWING SHALL BE READ IN CONJUNCTION WITH ALL RELATED DOCUMENTATION, DRAWINGS AND STANDARD DETAILS.
- THIS DRAWING SHALL BE READ IN CONJUNCTION WITH DRAWING 9443-D-01 PROPOSED SURFACE WATER DRAINAGE OUTFALL LAYOUT.
- THE WORKS SHALL BE CARRIED OUT IN ACCORDANCE WITH THE DOT MCDHW, DMRB AND THE LOCAL REQUIREMENTS OF ROYAL BOROUGH OF WINDSOR AND MAIDENHEAD
- ALL DRAINAGE OUTFALLS AND CONNECTIONS TO EXISTING SYSTEMS SHALL BE CHECKED & SURVEYED AND THE RESULTS PASSED TO THE OVERSEEING AUTHORITY / CLIENT IN ADVANCE OF THE START OF DRAINAGE WORKS.
- THE CONTRACTOR SHALL CONDUCT THE WORKS WITH DUE REGARD TO THE ECOLOGICAL, ENVIRONMENTAL REQUIREMENTS OF THE SCHEME.
- THE CONTRACTOR SHALL TAKE SUCH STEPS TO SAFEGUARD AGAINST CONTAMINATION OF LOCAL WATERCOURSES.
- CONFLICTING INFORMATION SHOWN ON THE ENGINEER'S DRAWINGS OR DISCREPANCIES BETWEEN THE INFORMATION GIVEN BY THE ENGINEER AND THAT PROVIDED BY OTHERS MUST BE REFERRED TO THE ENGINEER BEFORE THE WORKS COMMENCE.
- THE CONTRACTOR SHALL USE SETTING OUT COORDINATES AND DIMENSIONS PROVIDED WHICH TAKE PREFERENCE OVER ANY LESS ACCURATE SCALED DIMENSIONS.
- TEMPORARY WORKS DESIGN ASSOCIATED WITH THE CONSTRUCTION OF THE WORKS SHALL BE RESPONSIBILITY OF THE CONTRACTOR.
- CALCULATIONS AND DRAWINGS OF ALL CONTRACTOR DESIGNED ITEMS SHALL BE SUBMITTED TO THE ENGINEER FOR COMMENTS / APPROVALS NOT LESS THAN 10 WORKING DAYS PRIOR TO CONSTRUCTION. ANY COMMENTS MADE BY THE ENGINEER DO NOT ABSOLVE THE CONTRACTOR OF HIS DESIGN RESPONSIBILITIES.
- ALL WORKS AND PROGRAMMING SHALL BE AGREED IN ADVANCE WITH THE OVERSEEING ORGANISATION AND THE CLIENT.
- THE CONTRACTOR SHALL MAINTAIN FREE AND OPEN ACCESS TO THE PUBLIC HIGHWAY AND ADJACENT LANDS AND PROPERTIES AT ALL TIME UNLESS OTHERWISE AGREED IN WRITING WITH THE INTERESTED PARTIES.
- ALL IRONWORKS NOT ABANDONED TO BE RAISED / LOWERED TO SUIT FINISHED LEVELS. IRONWORKS SHALL BE BOUNDED WITH RAMPED BITUMINOUS MATERIALS PENDING COMPLETION OF THE GROUND LEVELS.
IT IS NORMALLY THE DUTY OF THE DESIGN CONSULTANT TO SECURE S104 ADOPTION APPROVALS PLUS S106 CONNECTION APPROVAL.
THE DESIGN CONSULTANT IS ADVISED TO REVIEW THE FINDINGS OF THE FLOOD RISK ASSESSMENT FOR THE SCHEME PRIOR TO COMMENCING ON SITE.
- THE CONSULTANT SHALL BE RESPONSIBLE FOR OBTAINING ALL TECHNICAL APPROVALS RELATING TO DRAINAGE STRUCTURES DESIGNED BY THE CONTRACTOR OF HIS PROPRIETARY SYSTEM SUPPLIER. THE CONTRACTOR SHALL ARRANGE ANY SUCH INSPECTIONS DEEMED NECESSARY BY THE ADOPTING OF THE PROPOSED DRAINAGE ELEMENTS AND COVER ALL RELATED COSTS.
- REFER TO MLM DRAWING 667769-DWG-SBU-C-100-P3 FOR SITE WIDE DRAINAGE LAYOUT.

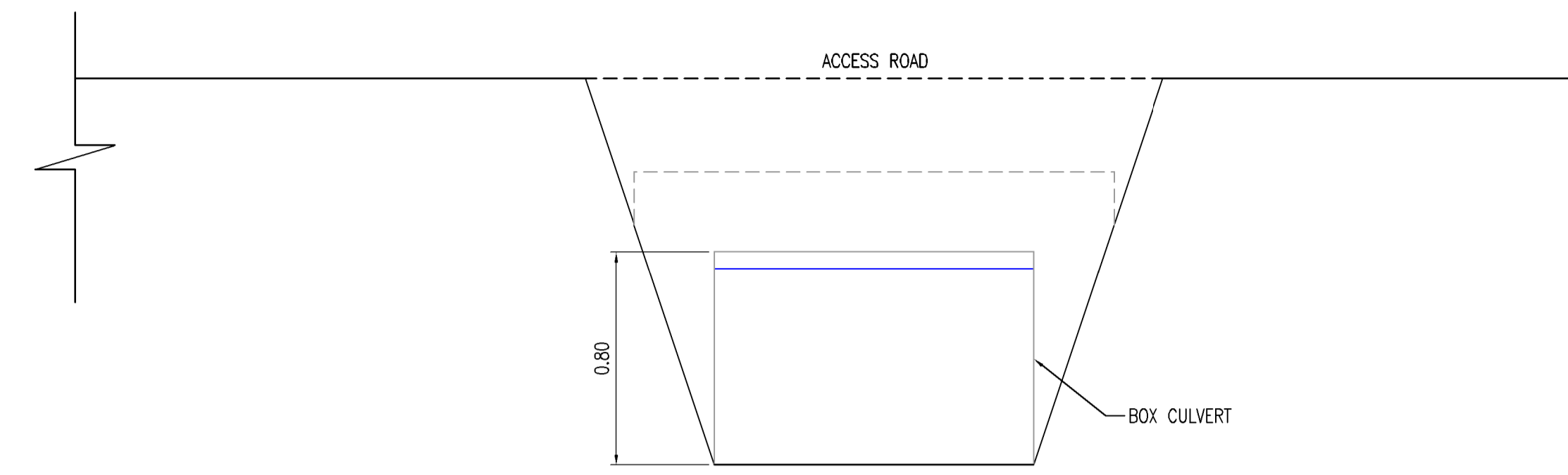

A-A

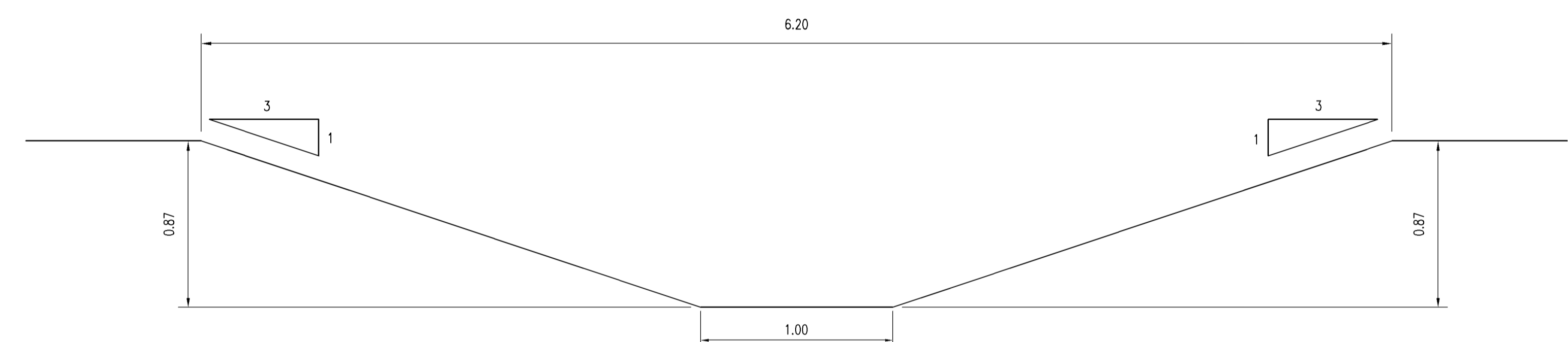

B-B

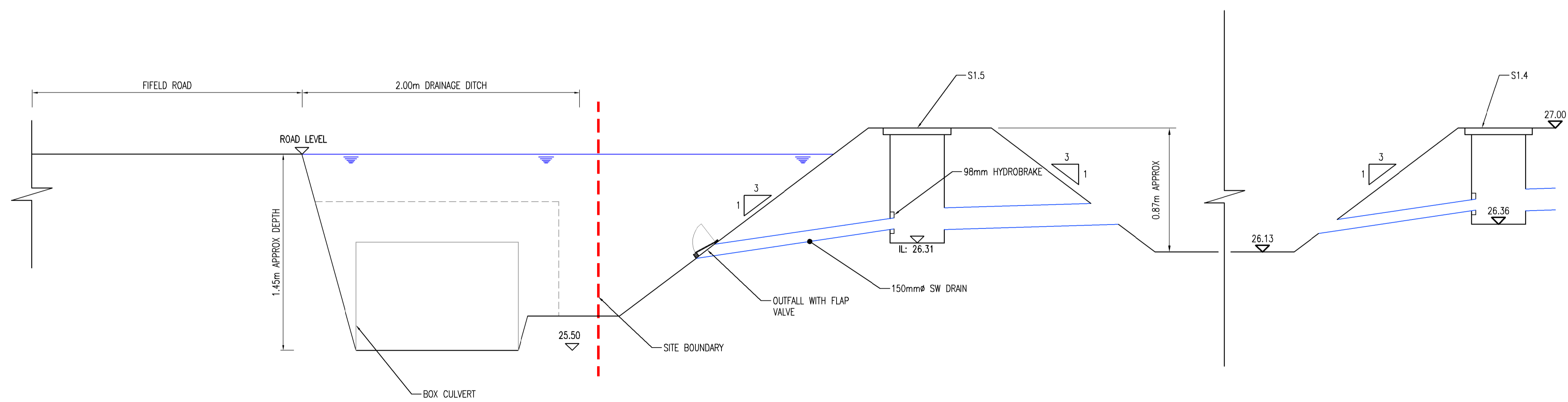

C-C

REV	DATE	BY	DESCRIPTION	CHK	APP
P01	09/11/2017	CT	FIRST ISSUE	ES	MPV

DRAWING STATUS: S2 - FOR INFORMATION

Mountbatten House, Basing View, Basingstoke, RG21 4HJ, UK
T+ 44 (0) 1256 318 800, F+ 44 (0) 1256 318 700
wsp.com

CLIENT: WATER OAKLEY LTD

ARCHITECT:

SITE/PROJECT: PHEONIX GYMNASIUM CLUB

TITLE: PROPOSED SURFACE WATER DRAINAGE SECTIONS

SCALE @ A1:	CHECKED:	APPROVED:	
1:20	RS	MHW	
PROJECT NO:	DESIGNED:	DRAWN:	DATE:
70039443	CT	CT	November 17

DRAWING NO:	REV:
9443-D-02	P01

© WSP UK Ltd

File name: \\UK\WSPGROUP\COMMON\DATA\PROJECTS\70039443\PHOENIX GYM CLUB - CONSTRUCTION\WSP\DEVELOPMENT\02 DRAWINGS\9443-D-02.DWG, created on 09 November 2017 15:52:48 by Trosiek, Calum